

TOPSFIELD ROAD (RT 97)

TIES TO SEPTIC COMPONENTS

- AC - 17' 8"
- BC - 20' 3"
- AD - 21'
- BD - 23' 6"
- AE - 23' 3"
- BE - 25' 5"
- AF - 26' 3"
- BF - 28' 5"
- AG - 30' 1"
- BG - 32' 8"

INVERTS OF PIPES

- 1 - 97.06    7 - 98.00
- 2 - 96.72    8 - 98.00
- 3 - 96.66    9 - 98.00
- 4 - 97.11    10 - 97.78
- 5 - 97.28    11 - 97.77
- 6 - 97.90    12 - 97.78

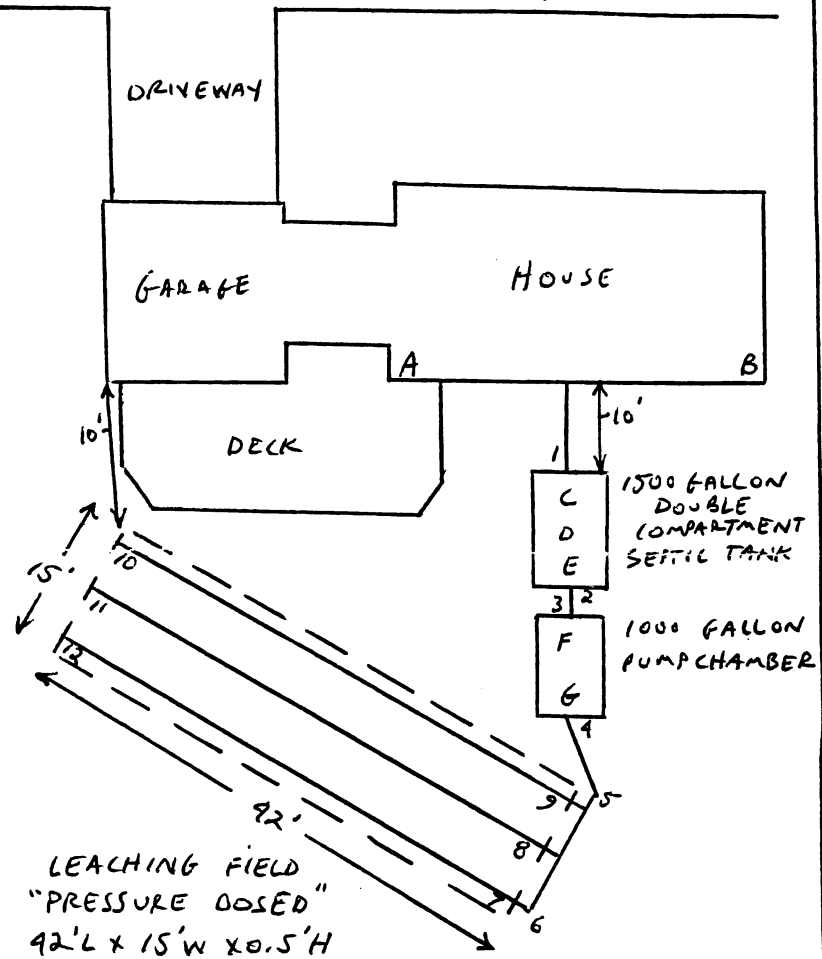

LEACHING FIELD  
"PRESSURE DOSED"  
42'L x 15'W x 0.5'H

NOTE: ZABEL FILTERS EXIST IN SEPTIC TANK BELOW COVERS D & E.

**CALL**

**G.H. RICKER, INC.**  
Providing Professional Service Since 1929  
50 R. Highland Street  
SOUTH HAMILTON, MA 01982  
(978) 468-4055

for service

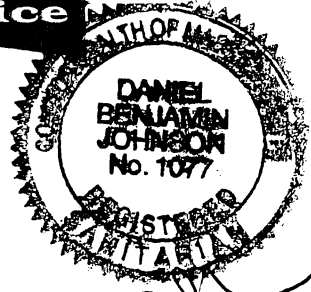

*Handwritten signature and date: 10/4/00*

\* REF. APPROVED PLAN FOR FURTHER DETAILS

**AS BUILT OF SEPTIC DESIGN**

132 TOPSFIELD ROAD, WENHAM

**DOMESTIC SEPTIC DESIGN, INC.**  
63 CAPTAIN ALDEN'S LANE  
OSTERVILLE, MA 02655  
(508) 420-1904

DATE: 10/4/00

SCALE: NONE

last inspection  
3/4/04